

# FUERA

Surface mounted IP66 LED luminaire.

<b>Mounting:</b>	Directly on the ceiling
<b>Body material:</b>	Polycarbonate
<b>Colour:</b>	Standard Gray , white diffuser
<b>LED module:</b>	Signify (Philips), Osram, Tridonic or equivalent LED module included
<b>Colour temperature:</b>	4000K
<b>Colour Rendering Index (CRI):</b>	>80 in standard
<b>Driver:</b>	EVG
<b>Emergency unit:</b>	On request
<b>Movement sensor:</b>	On request
<b>Daylight control sensor:</b>	On request
<b>Operating temperature range:</b>	- 20°C ... +40°C
<b>IP Class:</b>	IP66
<b>Power:</b>	220-240V 50/60Hz
<b>Lighting direction:</b>	Direct
<b>Reflector type:</b>	Aluminium white
<b>Light distribution:</b>	Symmetric
<b>General data:</b>	5 Years standard warranty

Different lumen output or wattage available on request

All other technical features such as: Luminaire Efficacy, LOR, Lumen maintenance L/B etc. available in our pricelist

Wattage of products may vary due to constant LED efficacy improvements. Luminous flux & Luminaire Power tolerance +/- 10%.

System power consumption (LED module & driver) depends on components used

Efficacy depends on type of LED's, electronics, optics and diffuser and may differ from shown in our data pages. Most up to date information can be found in our lighting data file database.

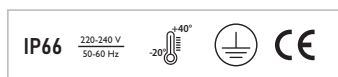

## Drawing

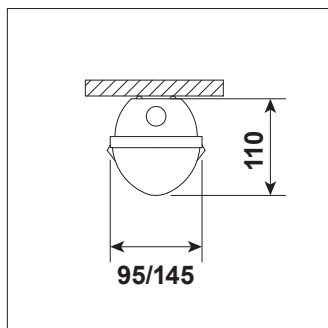

Available versions

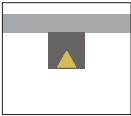

FUERA

Product code	Product name	Gross Lumen [lm]	Nett Lumen [lm]	Power [W]	Efficacy [lm/W]	Colour temperature [K]	Length [mm]	Width [mm]	Height [mm]	Nett Weight [kg]
Surface mounted, light down, IK10										
70.00120.84.E.KM	FUERA 1200/3270lm/840/E/KM	3270	2880	20	144	4000	1272	95	110	1,7
70.00121.84.E.KM	FUERA 1200/4100lm/840/E/KM	4100	3610	25	144	4000	1272	95	110	1,7
70.00122.84.E.KM	FUERA 1200/5550lm/840/E/KM	5550	4880	35	139	4000	1272	95	110	1,7
70.00123.84.E.KM	FUERA 1200/6540lm/840/E/KM	6540	5750	40	144	4000	1272	145	110	2,2
70.00124.84.E.KM	FUERA 1200/8200lm/840/E/KM	8200	7210	50	144	4000	1272	145	110	2,2
70.00125.84.E.KM	FUERA 1200/9650lm/840/E/KM	9650	8525	60	142	4000	1272	145	110	2,2
70.00126.84.E.KM	FUERA 1500/4090lm/840/E/KM	4090	3600	26	138	4000	1572	95	110	2,3
70.00127.84.E.KM	FUERA 1500/5130lm/840/E/KM	5130	4510	37	122	4000	1572	95	110	2,3
70.00128.84.E.KM	FUERA 1500/6710lm/840/E/KM	6710	5900	45	131	4000	1572	95	110	2,3
70.00129.84.E.KM	FUERA 1500/8180lm/840/E/KM	8180	7200	51	141	4000	1572	145	110	2,9
70.00130.84.E.KM	FUERA 1500/10260lm/840/E/KM	10260	9030	73	124	4000	1572	145	110	2,9
70.00131.84.E.KM	FUERA 1500/13880lm/840/E/KM	13880	12210	86	142	4000	1572	145	110	2,9